

Video Splitter

4K60 DisplayPort EDID/HDCP Feeder with 2 Ports Splitter Function, 2 DP Outputs

Model: VSP-4KD-2DP

PRODUCT OVERVIEW

➤ DisplayPort EDID Emulator, 1x2 DP Splitter, 4K@60(4:4:4), HDCP

The **VSP-4KD-2DP** DP EDID Emulator distributes DisplayPort video output to two DP monitors. Its built-in HDCP key acts as a coordinator between the source and display device to ensure uninterrupted digital video streaming.

➤ EDID Feeder: EDID Emulator (DDC Ghost)

The EDID Auto Learning and EDID Copy functions allow the DP EDID Emulator to either read the necessary EDID information from the splitter unit itself or copy EDID from EDID-compliant monitors (DP1 or DP2), ensuring accurate display output. The DP EDID Emulator aggregates EDID feeds from either a DisplayPort 1 or DisplayPort 2 compliant monitor and supports both Permanent (EDID Copy) and Temporary (EDID Auto Learning) EDID configurations.

Note: EDID Auto Learning records EDID information but data will be erased after hot-plugging or power-off.

➤ DP++ (DisplayPort Dual Mode)

The **VSP-4KD-2DP** supports Dual-Mode DisplayPort (DP++), enabling compatibility with DisplayPort, DVI, and HDMI monitors. It allows DP signals to be converted to DVI or HDMI signals via a simple cable adapter.

Note: An adapter cable is required for the different video connector ends.



FEATURES

- 4K@60Hz DisplayPort EDID Feeder design with HDCP engine ensures smooth and optimum display effect
- Allows restoration of 2 customized EDID information or copying EDID from the connecting display
- Prevents the computer from deactivating DisplayPort ports
- Economical, durable, and dependable
- Supports over 100 popular resolutions
- EDID Ghost (DDC Ghost)
- DP++ allows DisplayPort signal to be economically and conveniently converted to DVI or HDMI signal via passive adapter

Side View



Video Splitter

SPECIFICATIONS

Parameter	Descriptions
Max Video Resolution	3840x2160@60Hz (4:4:4)
Video Input	DisplayPort x 1
Video Output	DisplayPort x 1 (Main) Or DisplayPort x 1 (Aux) (DP++)
HDCP Engine	Yes
Slide Switch	EDID Copy x 1
Push Button	EDID Copy x 1
LED Indicator	Multi-Color x 2
HDCP Compliance	HDCP 1.4 / 2.2
Power Supply	DC 5V (Mini-USB)
Operating Environment	0 ~ 40°C, Humidity < 80%
Storage Temperature	-20 ~ 60°C
Enclosure	Metal
H x W x D (mm)	21 x 80 x 51
Weight (g)	150
Warranty	1-Year Limited Warranty. Advance Replacement Warranty is available.

Top View

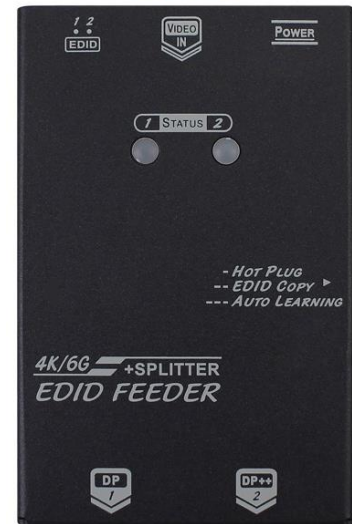

CONNECTION DIAGRAM

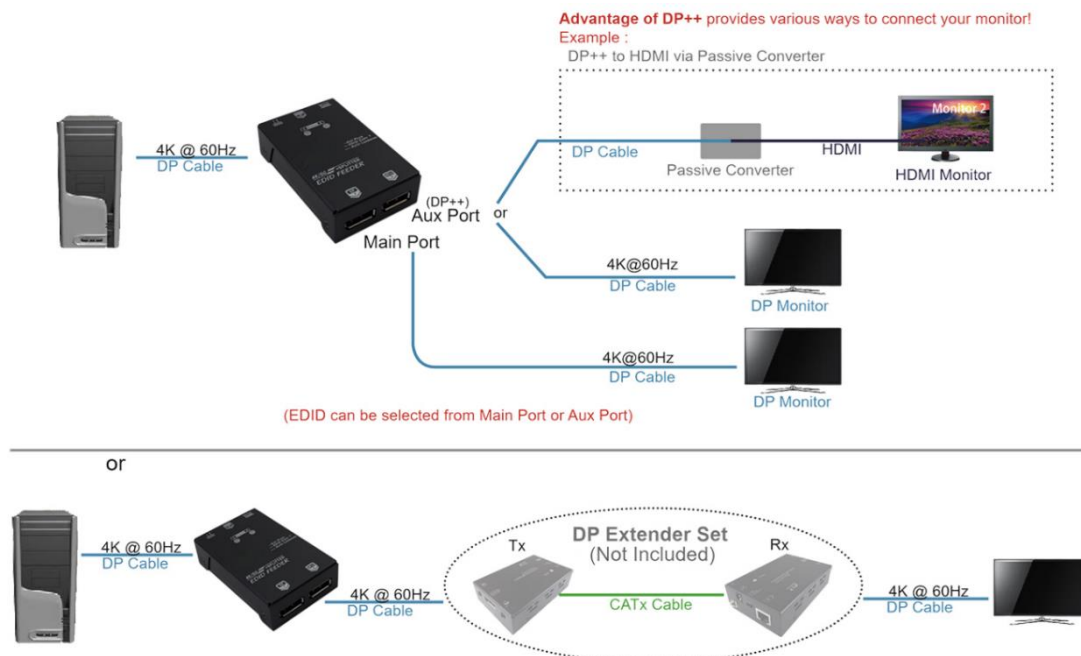

DISCLAIMER

DSGio shall not be liable for any damages, including punitive, consequential, or cost of cover damages, arising from any errors in the product information or specifications provided in this document. This document is subject to revision by DSGio at any time without prior notice.